

FENDER FLARE INSTALLATION INSTRUCTION

NISSAN TITAN 04-15 (with Storage Door)

Item No. FLZ209711 (Rivetz Style)

- Qty (1) Fender Flare Left Front (LF)
- Qty (15) S-Clip & Machine Screw
- Qty (1) Fender Flare Left Rear (LR)
- Qty (2) Fastener w/ Spacer 5mm
- Qty (1) Fender Flare Right Front (RF)

Parts

- Qty (1) 13 mm Spacer
- Qty (1) Fender Flare Right Rear (RR)
- Qty (36) Allen Bolt, Nut & Washer (Hex Key required)
- Qty (1) Rubber Seal(enough for four flares's outer edge)
- Qty (8) Self Tapping Screw(see optional B)

Step 1. Pre-Installation

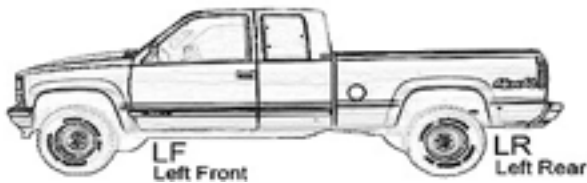

Prefit and ensure both left (driver) side & right (passenger) side fender flare to the vehicle before painting or installation. You may remove any moldings, strips or existing flares from the vehicle for fitting and installation.

Step 2. Painting (optional)

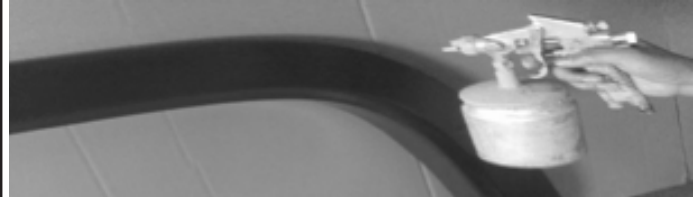

Hire a professional painter or body shop and follow the paint manufacturer specifications to paint the flares. Clean all fender flare surface with clean water & a mild detergent before paint, don't use lacquer thinner or any solvent based product.

Step 3. Cleaning



Wash and wipe dry the areas of contact on the vehicle body. Clean the surface and inside edge of the fender flare where the rubber seal is to be attached.

Step 4. Apply Rubber Seal



Remove 1 inch tape liner from rubber seal, apply it on the flare, start one end & along the edge that comes in contact with body panel. Caution: **3M tape will stick on the inside of the flare.** Make sure the rubber seal along the edge well, and rip the tape liner off gradually, apply pressure on the tape in the same time to ensure that it adheres well. Trim excess rubber seal and so on.

Step 5. Installation for All Style (Left Front Flare Shown)

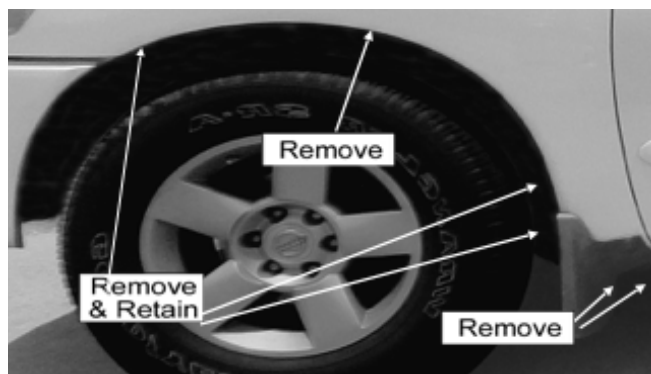

With Mud Flap- Remove existing screws & 1 extra screw above. save screws for reinstallation. (see illustration) **Without Mud Flap-** Remove 2 factory screws on the side, Remove 1 factory screw located at most front of fender, just above the bumper, save screw for reinstallation. Remove 1 factory screw located at most top of fender.

Step 6. Installation for All Style (Left Rear Flare Shown)

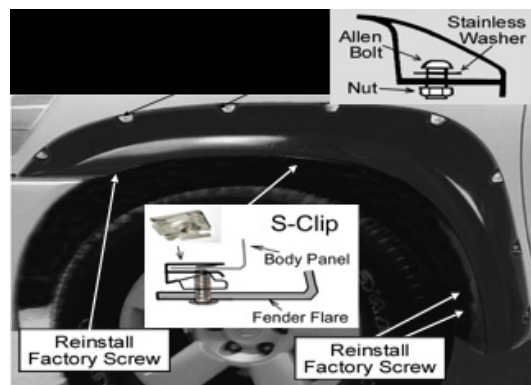

Use hex key to tighten allen bolt & nylon nut firmly on every pocket of the fender flares. **DO NOT OVER TIGHTEN !** Apply 2 S-Clip over 2 location and secure it with 2 machine screws.(Do not fully tighten screws) (see illustration) Line up the 3 holes in flare with factory holes and hold the flare firmly, reinstall 3 factory screws into the holes that were previously removed. (see illustration) Tighten the screws on S-Clip.

7. Installation (Right Rear Flare Shown)

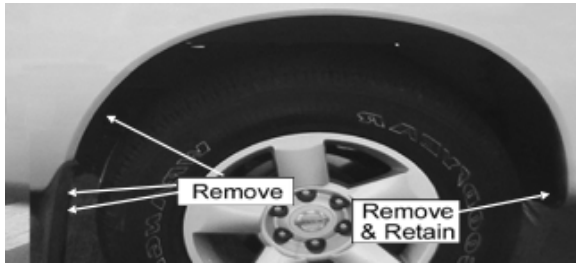

With Mud Flap

Remove existing screws & 1 extra screw above. (see illustration)
Remove 1 factory screw located at most front of fender, save screw for reinstallation. (see illustration)

8. Installation (Right Rear Flare Shown)

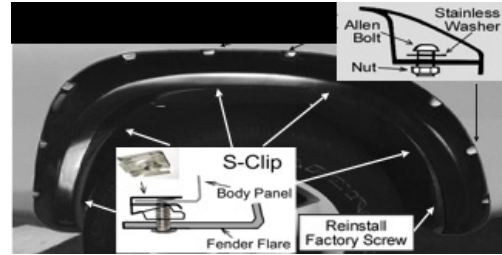

Use hex key to tight allen bolt & nylon nut firmly on every pocket of the fender flares. **DO NOT OVER TIGHTEN!** Apply 5 S-Clip over 5 location and secure it with 5 machine screws (**Do not fully tighten screws**) (see illustration) Line up the hole in flare with factory hole and hold the flare firmly, reinstall factory screw into the hole that were previously removed. (see illustration) Tighten the screws on S-Clip.

9. Installation (Left Front Flare Shown)

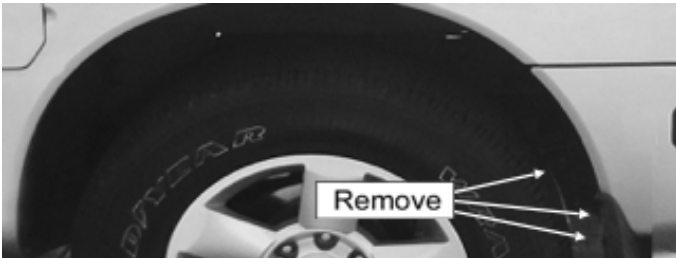

With Mud Flap

Remove existing screws & 1 extra screw above. (see illustration)

10. Installation (Left Rear Flare Shown)

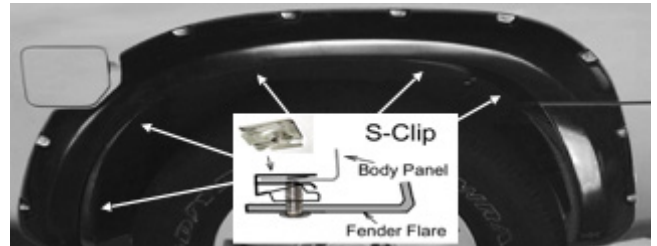

Apply 5 S-Clip over 5 location and secure it with 5 machine screws, as shown in illustration. (**Do not fully tighten screws**) Line up the flare properly and hold the flare firmly, tighten all screws, start from right side toward the access door.

11. Installation (Left Rear Flare Shown)

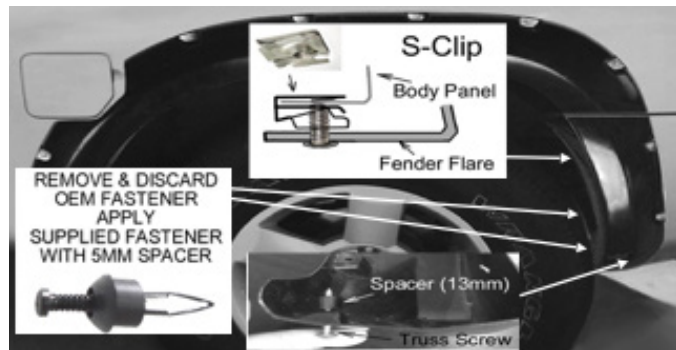

Without Mud Flap

Pry out the factory fastener on the bottom of the door and discard. Open the access door and remove the edge protector from the door lip and discard. Install supplied truss screw through spacer(13mm) into factory hole on the bottom of the fender, as lower right shown. (**Do not fully tighten screw**) Apply 1 S-Clip over the location and secure it with machine screw, as top shown.(Do not fully tighten screw) Apply 2 supplied fastener with 5mm spacer(on outside of flare) into factory holes, as center shown. Line up the flare properly and hold the flare firmly, tighten all screws.

12. Installation (Left Rear Flare Shown)

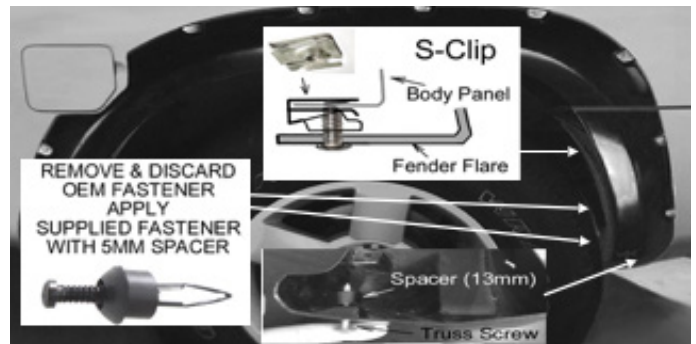

Without Mud Flap

Remove factory mud flap and save the hardware. Pry out the factory fastener on the bottom of the door and discard. Open the access door and remove the edge protector from the door lip and discard. Install supplied truss screw through spacer(13mm) into factory hole on the bottom of the fender, as lower right shown. (**Do not fully tighten screw**) Apply 1 S-Clip over the location and secure it with machine screw, as top shown.(Do not fully tighten screw) Apply 2 supplied fastener with 5mm spacer(on outside of flare) into factory holes, as center shown. Line up the flare properly, hold the flare firmly, tighten all screws.

Optional: Use the included self tapping screw to instead of the clip, clamp or any parts where it's not workable on the different condition of the fender or it may be used for extra secure when it be needed.